

#13454 Filed This 3 day of Dec 1968  
 And Recorded in Vol. 222 Page 115 at 2:21 P.  
 Ollie Sammons  
 Register Mesne Conveyance Greenville County, S. C.

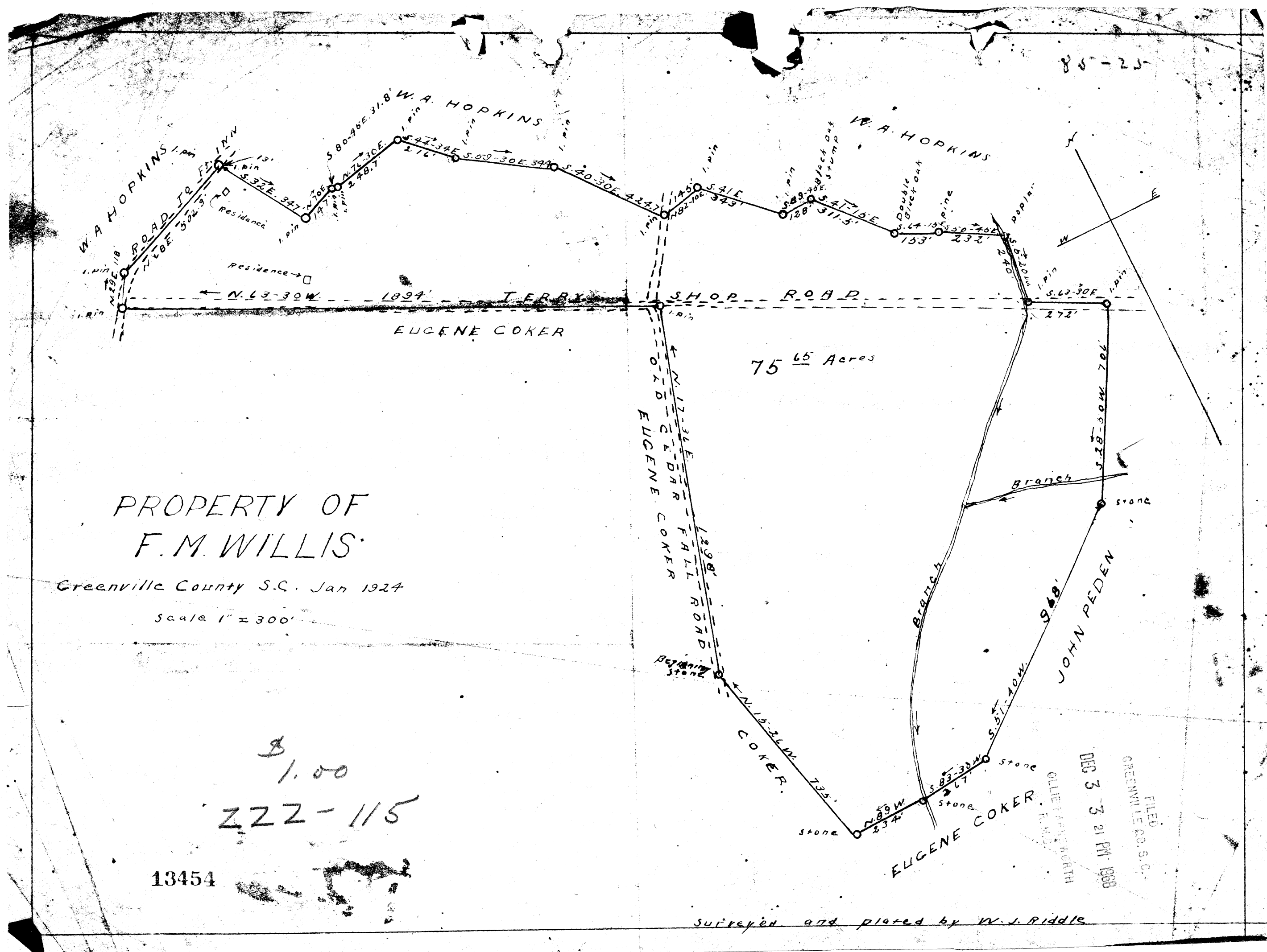

PROPERTY OF  
 F. M. WILLIS  
 Greenville County S.C. Jan 1924  
 Scale 1" = 300'

\$ 1.00  
 222-115

13454

Surveyed and plotted by W. J. Riddle

FILED  
 GREENVILLE CO. S.C.  
 DEC 3 3 21 PM 1968  
 OLLIE SAMMONS  
 REGISTER